

F.M. INSULATION SUPPLIES
INDUSTRIAL & COMMERCIAL INSULATION MATERIALS



TWO HOUR FIRE RATED PIPE PENETRATION SYSTEM

FRL 120/120/120 AT WALL AND FLOOR PENETRATIONS
IN ACCORDANCE WITH **AS4072** AND **AS1530.4-2014**

**THERM-O-LAG ROCKWOOL SPI WITH HD FOIL FACING IN
CONJUNCTION WITH 3M 3000WT INTUMESCENT SEALANT**

19 - 21 BROMLEY ROAD, EMU PLAINS NSW 2750

TELEPHONE: 02 4735 5699 MOBILE: 0417 230 030

EMAIL: info@fminsulation.com.au WEB: www.fminsulation.com.au



THE INSULATION CONTRACTORS ASSOCIATION

TICA Approved Supplier Listing

Products for Use in: Fire resistance of pipe penetrations (horizontal and vertical)

To whom it may concern;

This letter confirms that stonewool / rockwool pipe insulation as supplied by FM Insulation Supplies, ABN 90 067 287 307 form part of the TICA Approved Supplier Listing for product that can be used in relation to the testing noted below;

1. FP10422-001 October 2019 – Fire resistance of pipe penetrations in a steel stud / plasterboard wall
2. FP10422-002 October 2019 - Fire resistance of pipe penetrations in a 125mm thick concrete slab
3. DI11662-004 July 2019 – Thermal testing of an insulation - sample 4

This testing was carried out by Branz, 1222 Moonshine Road, RD1, Porirua, 5381 New Zealand

This letter is further to the Pipe Penetrations Systems - Certificate of Conformity as issued by TICA April 2020.

Supplier contact / product details;

Company name: FM Insulation Supplies

Manufacturer: Sitek Enterprises Stone Wool – China, minimum 100 kg/m³ density

Product code: HDffrwspi (pipe diameter) x (wall thickness)

Address: 19-21 Bromley Road, Emu Plains, NSW 2750

Office Tel: 02 4735 5699

Email: info@fminsulation.com.au

Website: www.fminsulation.com.au

On behalf of TICA

Dominic Santoro – Chairman TICA QLD - Tel: 0417 381 737

Dated: 19/05/2020

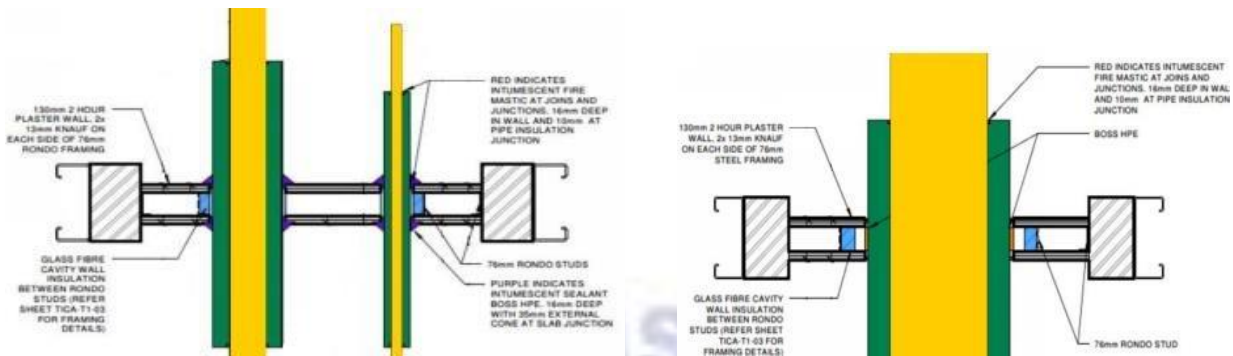

INSTALLATION FIRE PROTECTION – WALL

Diameter Pipe (mm)	Pipe Type	Insulation Thickness	Pipe Section (Each Side of Wall)
6.35 – 48.3	Copper / Steel	25mm	400
50.8 – 73.0	Copper / Steel	40mm	400
76.1 – 114.3	Copper / Steel	50mm	600
127 – 219.1	Copper / Steel	63mm	600
273.1 – 323.9	Steel Only	75mm	600
**355.6 – 711	Steel Only	75mm	900

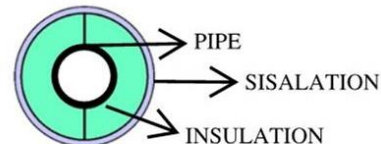
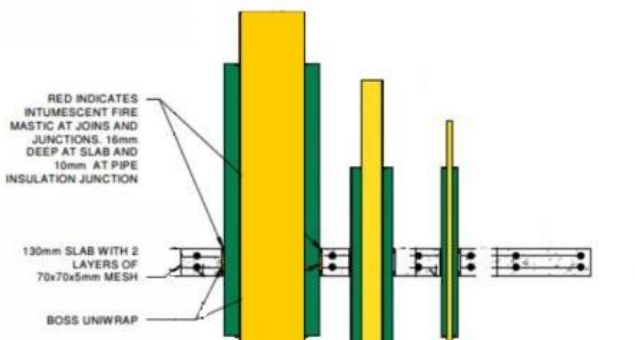

**** NOTE:** For Pipes 350 – 750 Diameter User Must Request Written Approval From TICA (Fees & Charges Will Apply)

INSTALLATION FIRE PROTECTION - SLAB

Diameter Pipe (mm)	Pipe Type	Insulation Thickness	Pipe Section (Under Slab)	Pipe Section (Over Slab)
6.35 – 48.3	Copper / Steel	25mm	300	300
50.8 – 73.0	Copper / Steel	40mm	300	400
76.1 – 114.3	Copper / Steel	50mm	400	400
127 – 219.1	Copper / Steel	63mm	300	600
273.1 – 323.9	Steel Only	75mm	300	600
**355.6 – 711	Steel Only	75mm	400	900



Wall test rig



Wall pre-test exposed face



Wall post-test exposed face



Floor pre-test unexposed face



Floor post-test exposed and unexposed face



Floor test rig